

ABERNATHY and ASSOCIATES

Kenneth B. Abernathy Jr.

Wisconsin Registered Land Surveyor S-1594

W4056 Bray Road
Elkhorn, Wisconsin 53121
Phone: (414) 723-4260 (office)
(414) 723-7209 (fax)

PLAT OF SURVEY

LOT 13 OF HIGH CREST SUBDIVISION
LOCATED IN THE NORTHWEST 1/4 OF THE
SOUTHEAST 1/4, THE NORTHEAST 1/4 OF THE
SOUTHWEST 1/4 AND THE NORTHWEST 1/4 OF
THE SOUTHWEST 1/4 OF SECTION 23, TOWN 1
NORTH, RANGE 15 EAST, WALWORTH COUNTY,
WISCONSIN.

THIS 30' WIDE STRIP IS RESERVED FOR THE
PLANTING OF TREES AND SHRUBS. THE BUILDING
OF ALL STRUCTURES, EXCEPTING PUBLIC AND
PRIVATE UTILITY STRUCTURES, HEREON IS
PROHIBITED.

LOT 12

LOT 13
40,023 S.F.

LOT 14

BUILDER
VERN GILBERT - GILBERT CONSTRUCTION
2523 COUNTRYSIDE DR.
DELAVER, WI. 53115

OWNER
SCOTT R. FORSYTHE
305 W. BROWN
HARVARD, IL. 60023

6' WIDE UTILITY EASEMENT

EXISTING RESIDENCE

PORCH FOUNDATION

UTILITY PEDESTALS

RAILROAD RIGHT - OF - WAY

DOUBLE DRIVE



SCALE 1" = 20 FEET

BEARINGS ARE BASED ON PLATTED
NORTH

Legend

- FOUND IRON PIPE
- FOUND IRON ROD
- FOUND BRASS CAPPED MONUMENT
- FOUND CONCRETE MONUMENT
- CHISEL CUT IN CONCRETE
- SET IRON ROD 24" LONG, WEIGHING 1.5 LBS./LINEAL FT., 3/4" DIA.
- SET IRON ROD 36" LONG, WEIGHING 4.5 LBS./LINEAL FT., 1-11/16" DIA.
- RECORDED AS DIMENSION
- EXISTING FENCE



SCALE: 1"=20 FEET

I hereby certify that the above described property has been surveyed
by me or under my direction and that the above map is a true
representation thereof and shows the size and location of the property,
its exterior boundaries, the location of all visible structures, and
dimensions of all principal buildings thereon, boundary fences, apparent
easements, roadways and visible encroachments, if any.
This survey is made for the use of the present owners of the property,
and also those who purchase, mortgage, or guarantee the title thereof
within one year from date hereof.

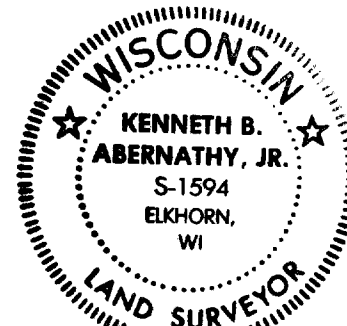

Kenneth B. Abernathy, Jr.
KENNETH B. ABERNATHY, JR.
WISCONSIN REGISTERED LAND SURVEYOR,
S-1594

Date: MARCH 13, 1997 Job No. 96.1203

EHCE-13
116-470